



Handling technology

Gripper series GPP1000

Gripper jaw set and fixation
material included

THE KNOW-HOW FACTORY

HANDLING TECHNOLOGY

GRIPPER SERIES GPP1000

▶ GPP1000 – EXPERTISE MEETS AFFORDABILITY



- ▶ Parallel gripper with an unbeatable price/performance ratio
- ▶ Gripper jaw set and fixation material included
- ▶ Can be configured for spring opening or spring closing
- ▶ One installation size, three strokes: 4, 8 and 16 mm per gripper jaw
- ▶ Gripping force of 100 N
- ▶ Service life of up to 2 million cycles

GPP1000: COST-EFFECTIVE

The GPP1000's unbeatably affordable price not only makes exceptionally cost-effective production a reality but also offers 100 N gripping force in three different strokes (4 mm, 8 mm, 16 mm) per gripper jaw. This single-acting gripper is supplied for use as an external gripper, for pressure-free opening using reset spring. A few simple manual adjustments are all that is needed to convert this gripper so that its jaws are closed when not under pressure. This means the gripper can also be used as an internal gripper.

Each gripper has two grooves for holding the magnetic field sensors used to sense the gripper's position. The grippers are supplied with a glasfiber reinforced gripper jaw set and the material required to attach them. However, customer-specific gripper jaws can be installed at any time.

An adapter plate (available as an option) can be used to attach the gripper to Zimmer's MCS and to any other standard profile rail system.

A CLEARLY STRUCTURED PRODUCT PORTFOLIO – ZIMMER GROUP



To make it easier for our customers to select the best product for them, the Zimmer Group has split its product portfolio into application classes, which we call "application profiles". The GPP1000 belongs to the AP1 base class, whose highly cost-effective products are designed to handle all the essential tasks. The GPP1000 has the same exceptional quality as you expect from all Zimmer Group products, at a very reasonable price. Able to run for up to 2 million cycles without maintenance, it meets all the requirements for reliable, cost-effective production!

HANDLING TECHNOLOGY

GRIPPER SERIES GPP1000

► FROM EXTERNAL GRIPPER TO INTERNAL GRIPPER IN 50 SECONDS

DELIVERY STATUS

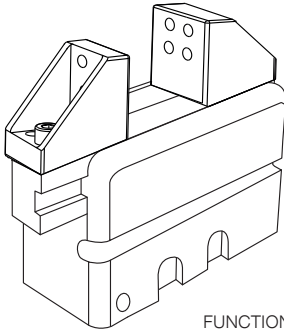

FUNCTION EXTERNAL GRIPPING

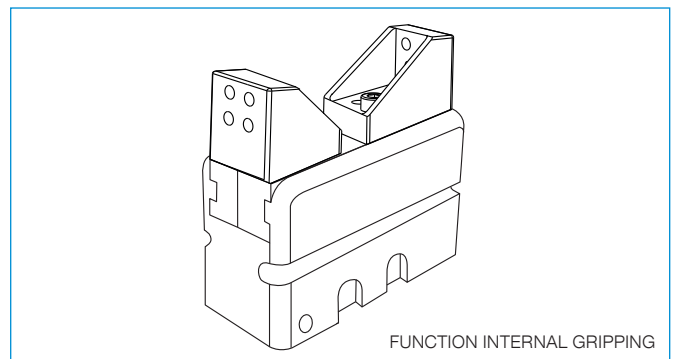
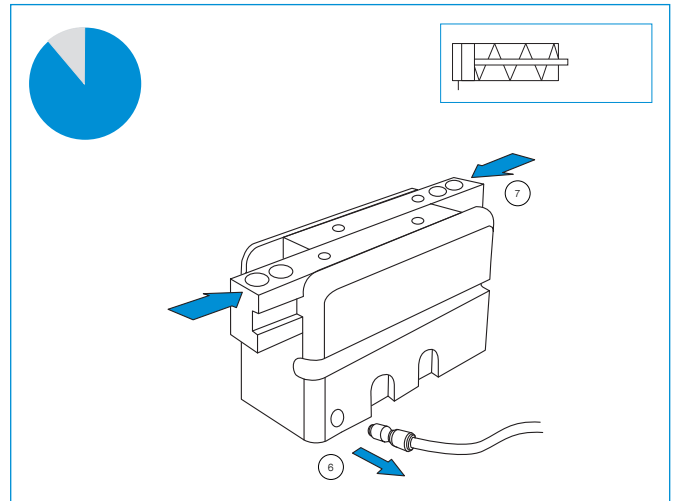
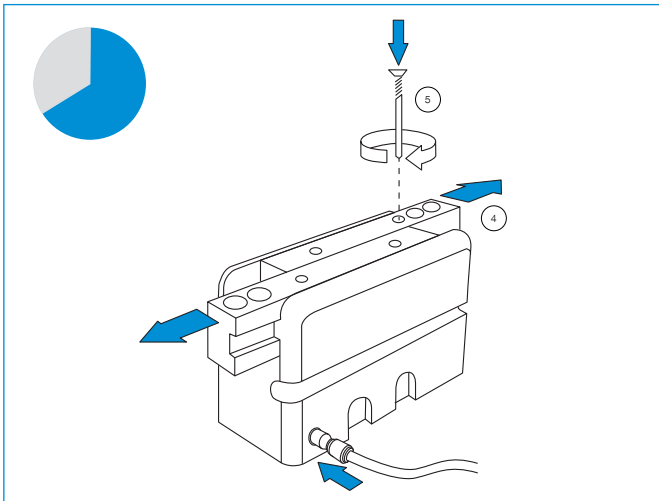
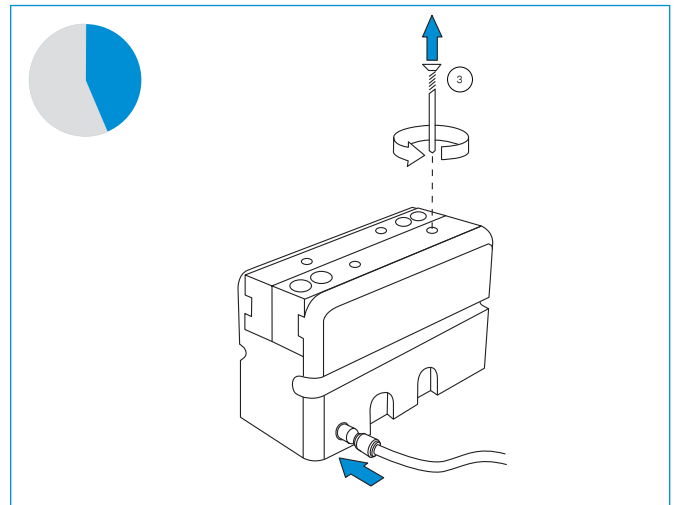
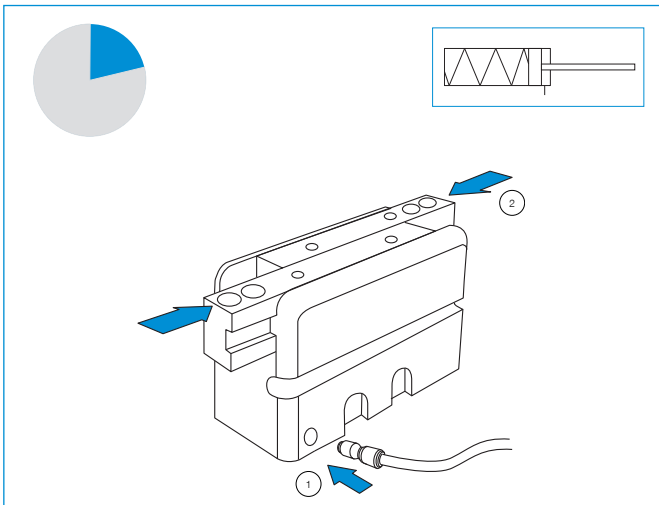

FUNCTION INTERNAL GRIPPING

2-JAW PARALLEL GRIPPERS

INSTALLATION SIZE GPP1108

▶ PRODUCT SPECIFICATIONS



▶ Gripping force diagram

Shows the arithmetic total of the individual forces that occur on the gripper fingers, depending on the gripper finger length

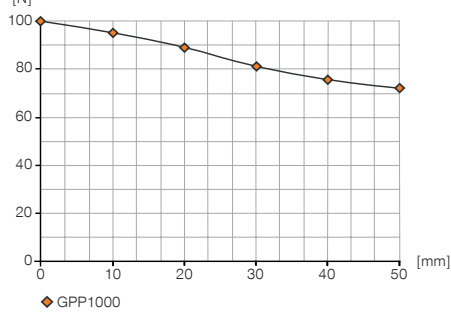

▶ Forces and moments

Displays static forces and moments that can also have an effect, besides the gripping force.

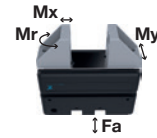

Steel top jaws Plastic top jaws

Mr [Nm]	4	1
Mx [Nm]	4	2
My [Nm]	2	1
Fa [N]	400	100

▶ Technical Data*

Order no.	GPP1108
Stroke per jaw [mm]	8
Grip force in grip direction min. [N]	100
Travel time in gripping direction [ms]	25
Reset time using spring [ms]	40
Weight per jaw max. [kg]	0.10
Repetition accuracy +/- [mm]	0.05
Operating pressure [bar]	2 ... 6
Operating temperature [°C]	5 ... +60
Air volume per cycle [cm³]	2.7
Protection to IEC 60529	IP30
Weight [kg]	0.17

* All data measured at 6 bar

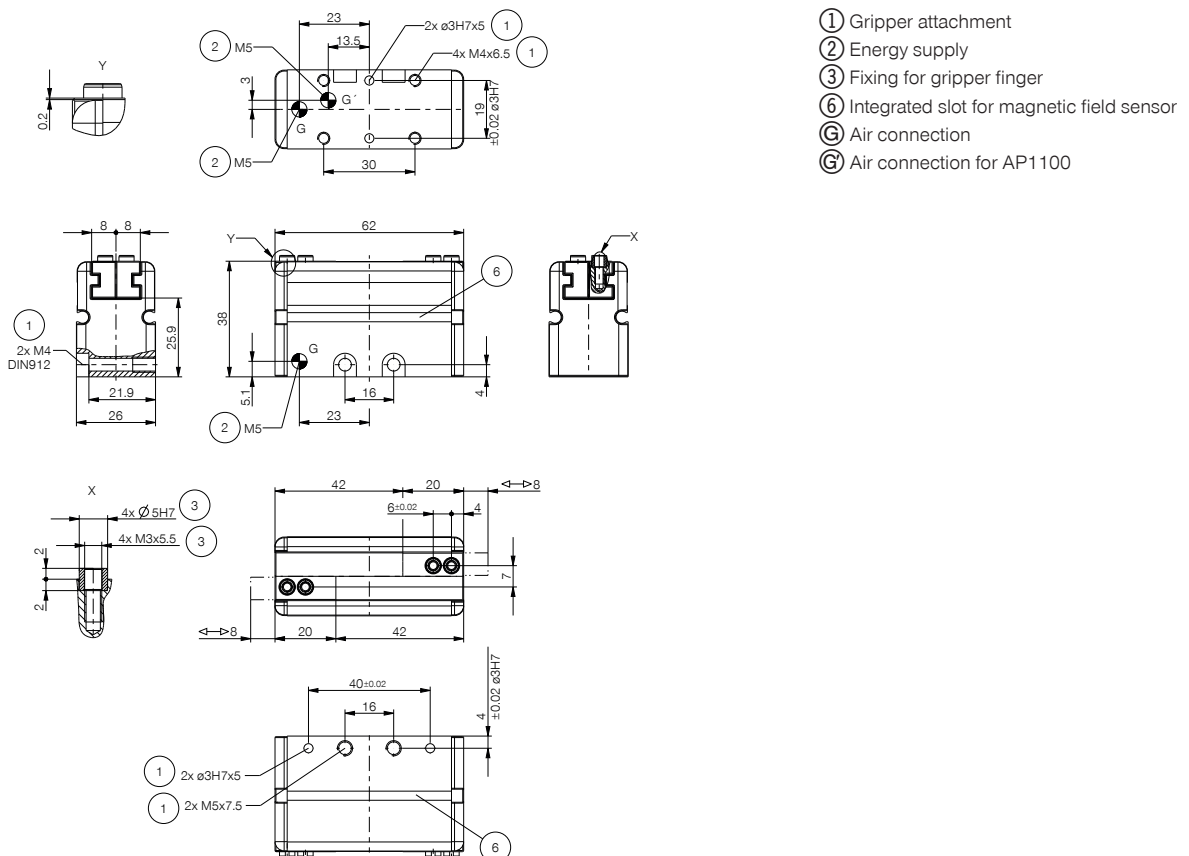

2-JAW PARALLEL GRIPPERS

INSTALLATION SIZE GPP1116

▶ PRODUCT SPECIFICATIONS



▶ Gripping force diagram

Shows the arithmetic total of the individual forces that occur on the gripper fingers, depending on the gripper finger length

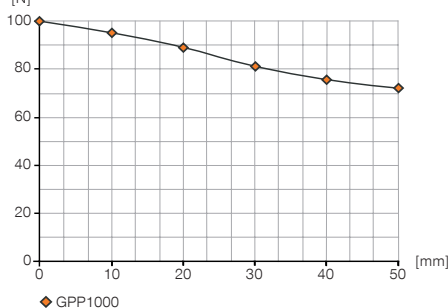

▶ Forces and moments

Displays static forces and moments that can also have an effect, besides the gripping force.

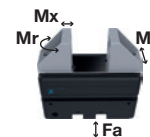

Steel top jaws Plastic top jaws

Mr [Nm]	4	1
Mx [Nm]	4	2
My [Nm]	2	1
Fa [N]	400	100

▶ Technical Data*

GPP1116

Order no.	GPP1116
Stroke per jaw [mm]	16
Grip force in grip direction min. [N]	100
Travel time in gripping direction [ms]	30
Reset time using spring [ms]	100
Weight per jaw max. [kg]	0.10
Repetition accuracy +/- [mm]	0.05
Operating pressure [bar]	2 ... 6
Operating temperature [°C]	5 ... +60
Air volume per cycle [cm ³]	5.6
Protection to IEC 60529	IP30
Weight [kg]	0.20

* All data measured at 6 bar

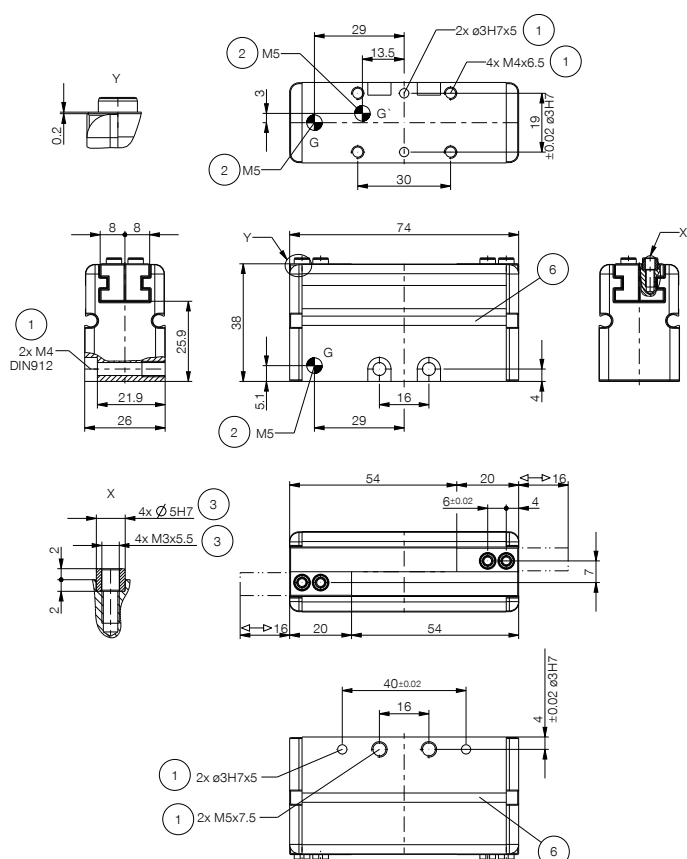

- ① Gripper attachment
- ② Energy supply
- ③ Fixing for gripper finger
- ④ Integrated slot for magnetic field sensor
- Ⓒ Air connection
- Ⓒ Air connection for AP1100

2-JAW PARALLEL GRIPPERS

SERIES GPP1000

INCLUDED IN DELIVERY

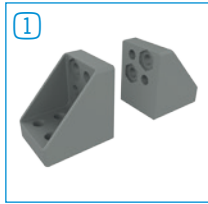

Plastic top jaws and assembly material
ZUB1100

44 Fixing for gripper finger

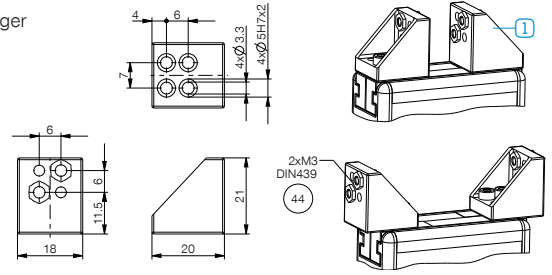

RECOMMENDED ACCESSORIES



PNP Magnetic field sensor Straight Cable 0,3 m - Connector M8
MFS1000SKHR



NPN Magnetic field sensor Straight Cable 0,3 m - Connector M8
MFS1000SKHR-NPN



Straight Fittings - Quick Connect Style
GVM5



Angled Fittings - Quick Connect Style
WVM5



MCS Adapter plate
AP1100



Straight Fittings - Quick Connect Style
GV1-4X6



Angled Fittings - Quick Connect Style
WV1-4X6

TECHNICAL DRAWINGS ACCESSORIES

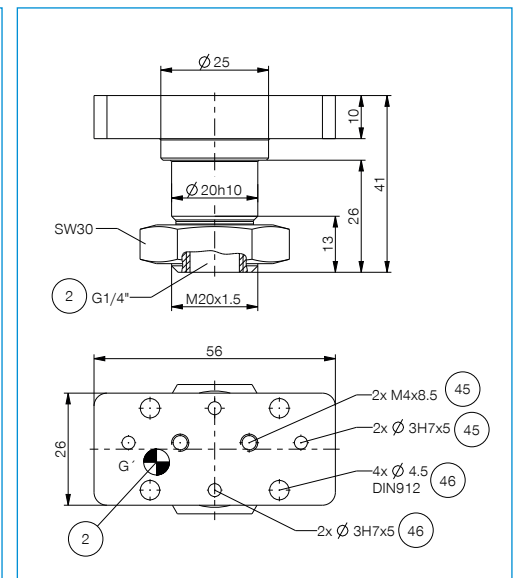
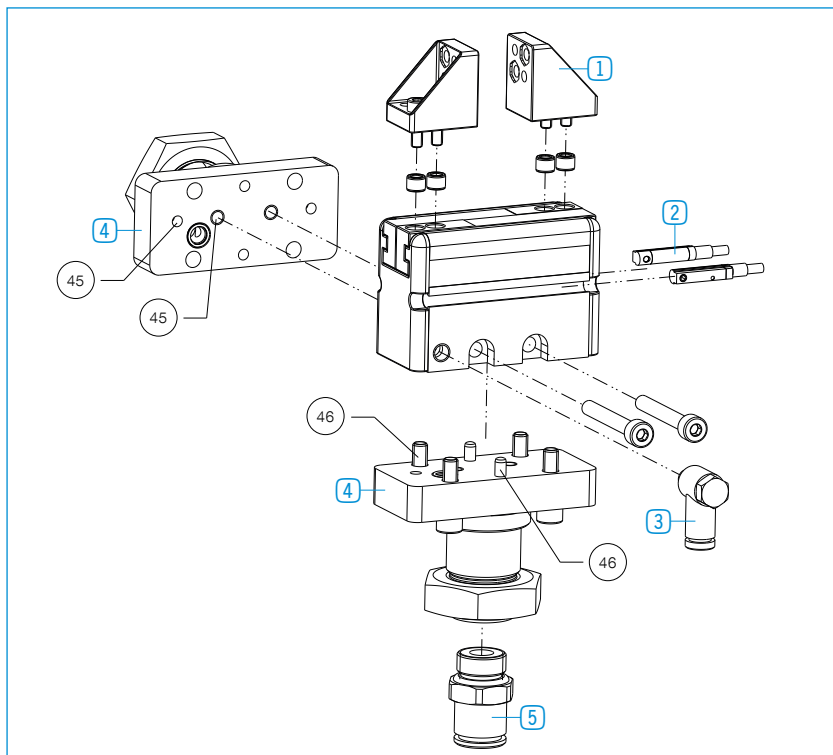

- ② Energy supply
- ④⑤ Horizontal mounting
- ④⑥ Vertical mounting
- ⓐ Gripper air connection