

# CLAMPING ELEMENTS | HYDRAULIC

## SERIES DKHS1000

### ► PRODUCT ADVANTAGES

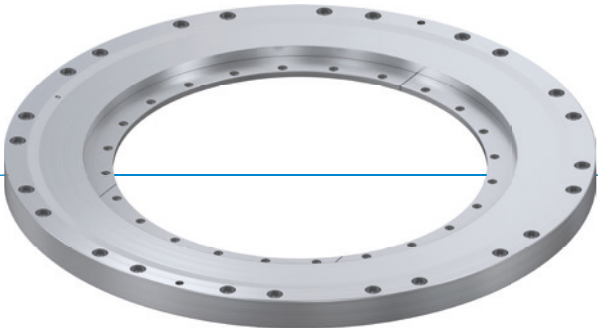

#### ► Highest accuracy in rotational axis

No moving functional parts and therefore backlash-free  
Drive can be taken out of the drive control

#### ► Fastest closing time and pressureless safety function

Due to a low displacement volume and internal stress of the housing

#### ► Market leading cycles

Housing strain stays below the elastic fatigue limit

### ► THE BEST PRODUCT FOR YOUR APPLICATION

#### APPLICATION SCENARIOS

- Torque take-up of shafts
- Clamping of torque drive
- Clamping of C-axis
- Fixing and safeguarding of swivel bridge
- Clamping of spindle tilting axis

#### ► Technical data

Series	DKHS1000
Shaft diameter	180-460 mm
Holding torque at 1 arcsec	800-6000 Nm
Holding torque at 5 arcsec	1300-8000 Nm
Pressure min. / max.	100 / 110
Spring storage	existing
PLUS connection	No
B10d value	up to 5 million
Dynamic braking cycles	not suitable
Operation	hydraulic
Operating temperature	5 ... +80 [°C]

## ► BENEFITS IN DETAIL

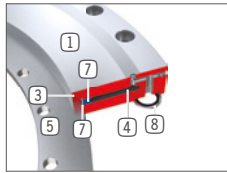
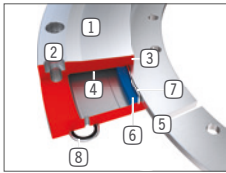

- ① Housing**
  - Holding torque due to pre-stressed, high tensile tool steel
- ② Housing connection**
  - Screw connection to the connecting construction
- ③ Clamping area**
  - Backlash-free Clamping of the rotary axis
- ④ Pressure chamber**
  - Opens the element under pressure in the elastic range
- ⑤ Shaft connection**
  - Connection with the rotary axis
- ⑥ Sealing**
  - Prestressed and self-enforcing under pressure
- ⑦ Retain plate**
  - Secures and holds the sealing in position
- ⑧ Hydraulic connection**
  - Sealing through O-Ring and surrounding cutting ring

## ► TECHNICAL DATA

### ► SERIES DKHS1000 HYDRAULIC CLAMPING NC (NORMALLY CLOSED) CLOSED WITHOUT PRESSURE

	Order no.	Shaft Ø [mm]	Holding torque		B [mm]	ØD1 [mm]	ØLK1 [mm]	ØLK2 [mm]
			at 1 arcsec	at 5 arcsec				
			[Nm]	[Nm]				
	DKHS1180-00-A	180	800	1300	20	308	308	169
	DKHS1200-00-A	200	1000	1600	20	328	328	189
	DKHS1220-00-A	220	1500	1900	20	348	348	209
	DKHS1240-00-A	240	1600	2200	20	368	368	229
	DKHS1260-00-A	260	1800	2600	22	388	388	249
	DKHS1280-00-A	280	2400	3000	22	408	408	269
	DKHS1300-00-A	300	2500	3100	22	428	428	289
	DKHS1320-00-A	320	2800	3900	22	448	448	309
	DKHS1340-00-A	340	3000	4200	22	468	468	329
	DKHS1395-00-A	395	4500	6000	26	523	523	382
	DKHS1460-00-A	460	6000	8000	26	598	598	447