

VACUUM EJECTOR

SERIES ZTM

▶ PRODUCT ADVANTAGES

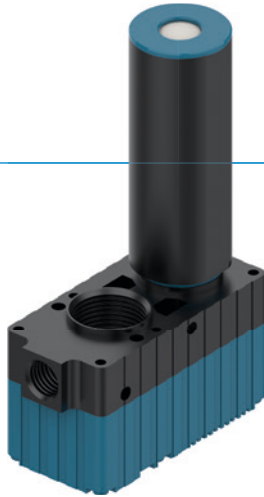

▶ High-performance

- Volume flow: 74 l/min–220 l/min
- Air consumption: 42 l/min–126 l/min
- Max. vacuum level: -85 kPa

▶ Excellent

The vacuum generator is characterized by a high volume flow with a low dead weight and compact design. It also stands out thanks to its great cost effectiveness.

▶ PRODUCT KEY

ZTM	20	S
Series	Installation size	Silencer

▶ TECHNICAL DATA

Order no.	▶ Technical data					
	Max. vacuum level [kPa]	Volume flow [l/min]	Silencer	Air consumption at 5.5 bar [l/min]	Operating pressure max. [bar]	Weight [kg]
ZTM10	-85	74		42	7	0.032
ZTM10-S	-85	74	Yes	42	7	0.032
ZTM20	-85	149		84	7	0.043
ZTM20-S	-85	149	Yes	84	7	0.043
ZTM30	-85	220		126	7	0.054
ZTM30-S	-85	220	Yes	126	7	0.054

▶ DIAGRAMS

ZTM10

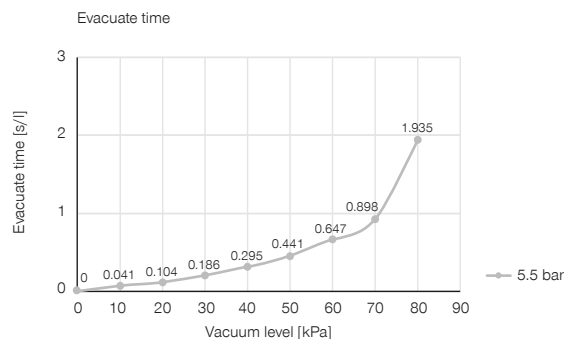
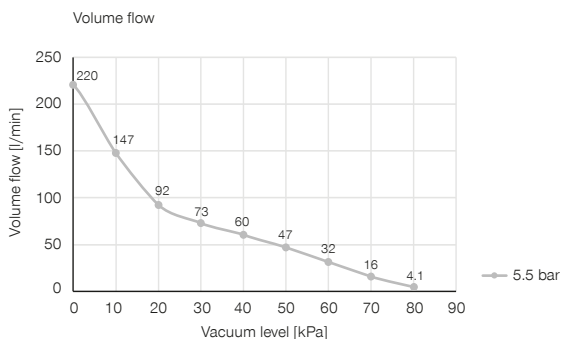

ZTM20

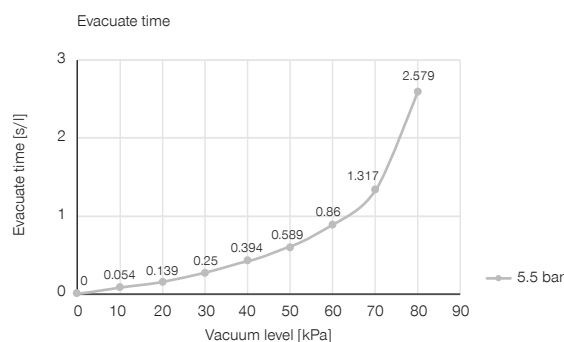
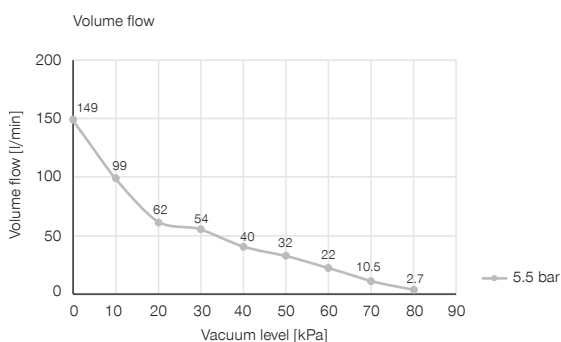

ZTM30

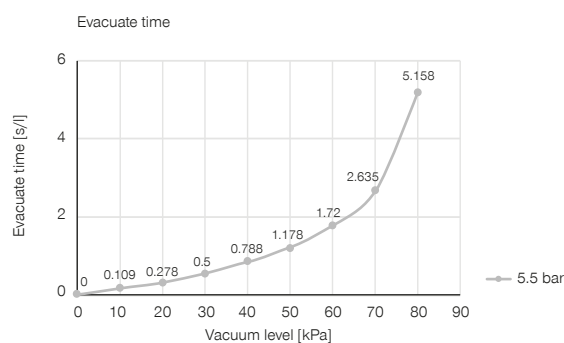
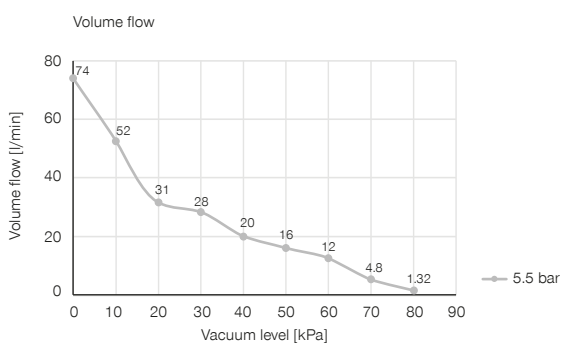

VACUUM EJECTOR SERIES ZTM

► TECHNICAL DRAWINGS

ZTM10

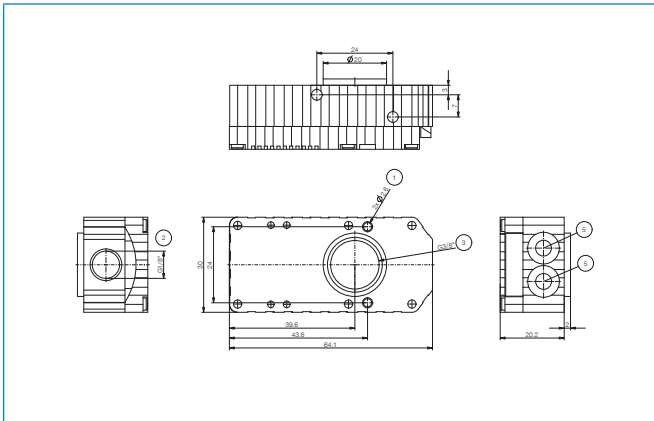

- ① Fixing
- ② Pneumatic connection
- ③ Vacuum connection
- ⑤ Exhaust air/exhaust air valve

ZTM10-S

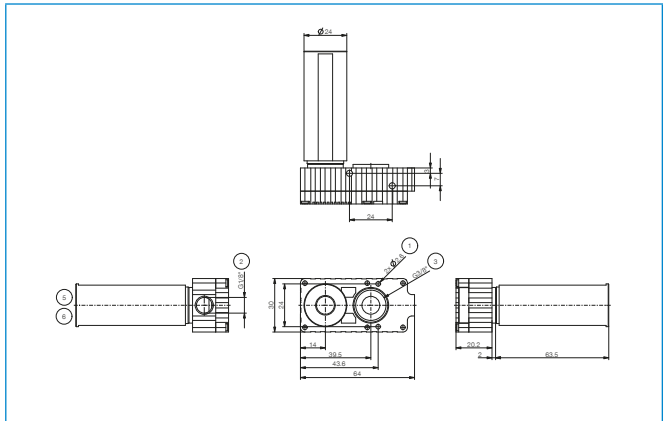

- ① Fixing
- ② Pneumatic connection
- ③ Vacuum connection
- ⑤ Exhaust air/exhaust air valve
- ⑥ Silencer

ZTM20

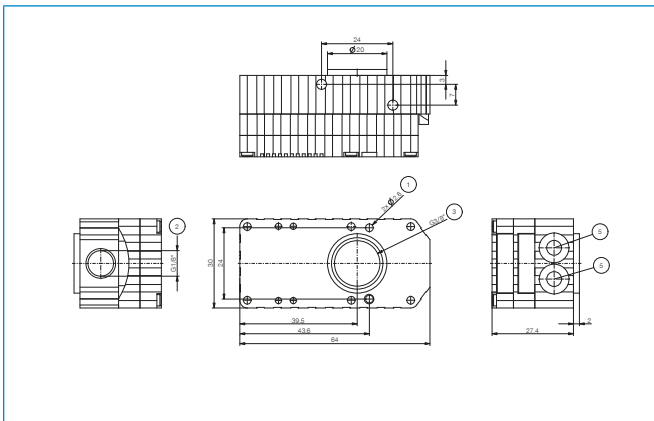

- ① Fixing
- ② Pneumatic connection
- ③ Vacuum connection
- ⑤ Exhaust air/exhaust air valve

ZTM20-S

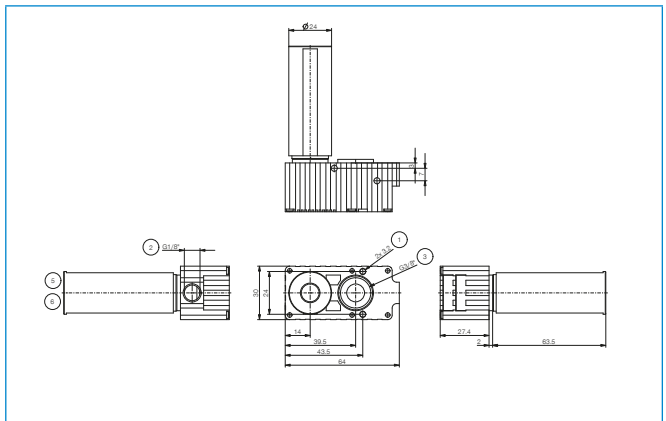

- ① Fixing
- ② Pneumatic connection
- ③ Vacuum connection
- ⑤ Exhaust air/exhaust air valve
- ⑥ Silencer

ZTM30

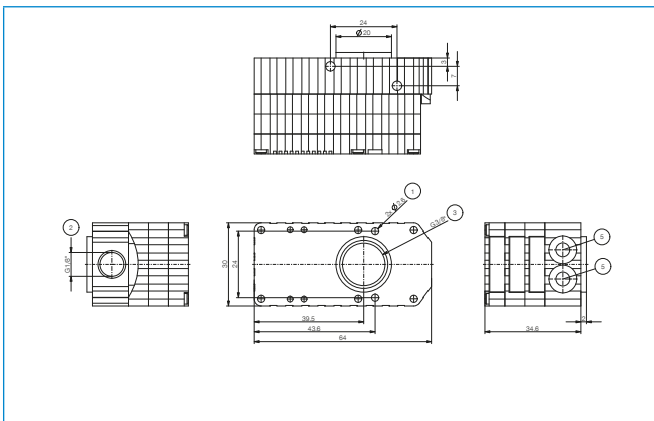

- ① Fixing
- ② Pneumatic connection
- ③ Vacuum connection
- ⑤ Exhaust air/exhaust air valve

ZTM30-S

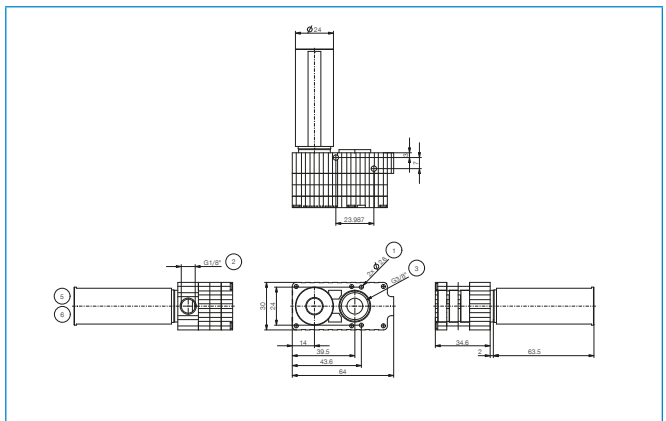

- ① Fixing
- ② Pneumatic connection
- ③ Vacuum connection
- ⑤ Exhaust air/exhaust air valve
- ⑥ Silencer